

Architecture Studio: 2nd Year Fall

Fall 2011, CMU, Arch #48-200, M/W/F 1:30-4:20
Class Website: www.andrew.cmu.edu/course/48-200

Coordinator: Kai Gutschow
Email: gutschow@andrew.cmu.edu
Off. Hr: M/F 12:00-1:00pm & by appt. in MM302

(9/15/11)

PROJECT 1 – BUILDING SHELTER

ASSIGNMENTS 1H: (for Mon. Sept. 12)

REVIT: Finish all 9 Revit tutorials and deposit to folder on archpcserver. Watch all 9 accompanying videos. They are all on the archpcserver at: \archpcserver\Studios\F11_48_200\R2_Revit_Tutorials_Conceptual_Design
- Divide your group in half so that approx. 28 people go to the Revit workshop on Monday, and an equal number go Wed. during studio. Collaborate with the entire studio to ensure equal numbers. Please go to Wean 5202 on Mon. at 1:30, OR to studio to continue work on your group's design. Collaborate!

READING: Please read Richard Sennett, The Craftsman, chs. 4,8. Files are available on Blackboard!

GROUP WORK: Start group design work in earnest. Set up consensus-building processes such as: electing a leader, devising a voting process, inventing rules to achieve compromise and break deadlocks, creating mini-competitions or charettes to start over or reinvent a particular piece of your design. Be ready to put your ego aside to work with the group's ideas; avoid taking "ownership" of design ideas, etc. Create a TEAM spirit!
- Invent a name or title for each design you create: give each design an identity, know WHY they look the way they do!

STRUCTURAL MODELS: Create at least one large scale, accurate, well-crafted "stick model" that shows every structural member of your shelter as it is currently designed. Use accurate-scale wood members. Avoid hot glue.

- Focus especially on the JOINERY. Devise strategies for joining the individual members, especially at non-orthogonal angles. Understand how the pieces need to be cut and screwed together. Consider making larger-scale (or FULL-scale) models of individual joints!
- Use basswood or other micro-cut lumber such as pine for the overall models. If they run out at the CMU Art Store, you will need to go further afield to buy it: Top Notch on Craig, Utrecht on Carson (Southside), or A.B. Charles on Banksville (South Hills). Consider also "making your own" mini-2x4s using the saws and planers in the shop... No balsa wood!!!
- If your team is still considering multiple design proposals, please make a separate model for each. Retain and bring to class all sketches and study models for "discarded" group themes. Save this process work!

SITE/SYSTEM DESIGN: Create at least one scenario for linking your shelter to your neighbors'. Work with the other group in your studio (or more groups) to show how they fit closely together. Be prepared to join together or show both models next to each other in reviews.

- Generate a conceptual "structure" for all the groups to collaborate in creating a unified assembly of individual shelters. Collaborate!
- This should involve creating a "site plan" and or a overall elevation of all the shelters so that they can create a "system." Is it an "open system" or a "closed system"?

INDIVIDUAL SHELTERS: Continue work on individual shelter designs as desired. How could you change or redesign your individual scheme to have it "fit" into a unified class "system" more easily?

- Be sure all work is recorded in digital form. Remember the assignment to submit a 50-frame file of your design process for each project.

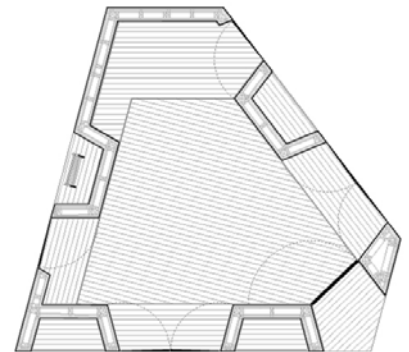

2x4 WORK: We will build ALL the remaining 2x4 project in studio next week. They have been great so far! Please retain the enthusiasm and remember your building techniques.

- Every studio should submit drawings and a compilation of photos of their designs to the designated archpcserver folder
- Every group should also upload photos to Flickr of your drawings, models, and design process.
- Consider uploading the most interesting schemes to the Classof2015 blog, along with some WRITTEN explanation.

FLICKR: Upload individual designs to Flickr. Rules for uploading F'11 pics:

- Each student should create a new set for Project 1. Title it:
Lastname Firstname F11 Project 1
(Please follow this format with the same capitalization & spacing)
- Then, tag your photographs as follows:
lastnamefirstname, f11project1 (stick to this format!)
- (Done after uploading photos and clicking "Add a description")

RESEARCH: Continue to do research on huts, on construction ideas, on other design-build projects in schools and around the world.

- Contribute ideas to the class blog, and WRITE a few lines about why it is significant or interesting.

